



FLOOR JOIST WALK THROUGH REPORT

This review is not a comprehensive inspection of the below named installation. It is a visual walk-through intended to help locate structural and/or installation errors. Floor system will perform best if installed per plan. Any changes or structural alterations should be reported to and approved by SPC in writing to maintain structural integrity. Please call with any questions you may have.

Subdivision:	Example		
Builder / ATTN:	Example		
Plan Name / LogIn:	C06116494	JobID: C06116494	
Inspected By:	BobMyles	Inspection Date:	1/1/1901
Permit#/Municipality:	Example		
Address:	Example		
Construction Stage @ time of inspection:	FIRST,SECOND,ROOF CEILING,		

Listed below are frequently occurring errors. Look for the corresponding reference number on the accompanying layout to indicate locations of problems. Possible repairs for identified problems are located on the reverse side of this form. Note that repairs are to be used only for specific situations as indicated an SPC representative.

A	Ceiling joists are over-spanned or spanning wrong direction	Ceiling Joists in BR2 spanning left to right... not to plan, but walls carry the weight properly
	Roof improperly braced or bracing installed to non-bearing location (Header, non-stacking wall...)	
	Ceiling Beams not installed as specified on SPC plan	
	Joist layout not per SPC plan; Start location, Spacing, Shifts or Extras	
	Joist(s) cut or damaged	
	Bearing walls do not appear to be level	
	Wall locations do not correspond with SPC plan	
	Beam incorrectly located per SPC plan	
	Minimum bearing not provided for beam or joist(s)	
B	Beam, Girder or Point Load From Above (P.L.F.A.) not properly supported. See detail "E" on reverse.	Pack all PLFA's in Joist space area
C	Exterior door header jacks not supported in joist space below. Refer to detail "A" on reverse	Pack all exterior Door jacks in joists space
	Hanger(s) missing. Install per SPC plan detail	
	Wrong hanger(s) installed	
D	Hanger(s) not nailed correctly or completely	Add some nails to the hangers
	No glue used in hanger seats. Use glue in hangers per SPC plan detail	
	Incorrect material installed. (Beam, Depth or number of plies. Header, Girder, Joist or Rim Band)	
E	Blocking panels omitted or removed. Refer to detail "C" on reverse	Two blocking panels remove---- re-install
	Deadwood improperly installed or omitted. Refer to detail "B" on reverse	
	Decking not properly installed with glue and nails or screws	
	Confirm that deck attachment conforms to pertinent building code	

Job Status:	PLBG,HVAC,ELEC,	
Additional Comments:	Good Framing Overall, Pack some Point loads & exterior door headers, add some blocking panels and add som nails to hangers for perfect installation.	Superintendant Signature and Printed Name
		<i>Example Signature</i>
		Example Super

WARNING: DO NOT SUPPORT DECKS FROM RIM BANDS AT CANTILEVERED CONDITION.

FLOOR JOIST WALK THROUGH REPORT

This review is not a comprehensive inspection of the below named installation. It is a visual walk-through intended to help locate structural and/or installation errors. Floor system will perform best if installed per plan. Any changes or structural alterations should be reported to and approved by SPC in writing to maintain structural integrity. Please call with any questions you may have.

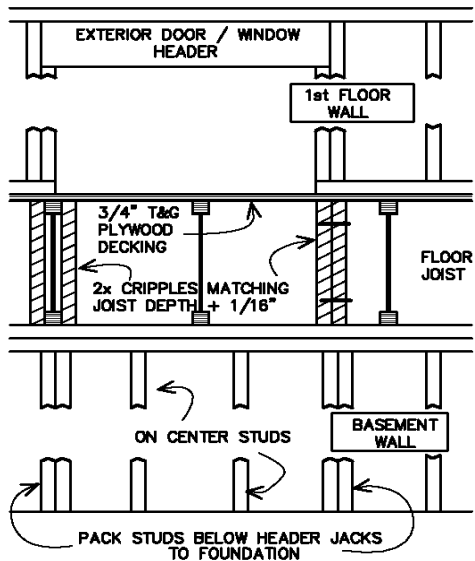

A DOOR JACK PACKING

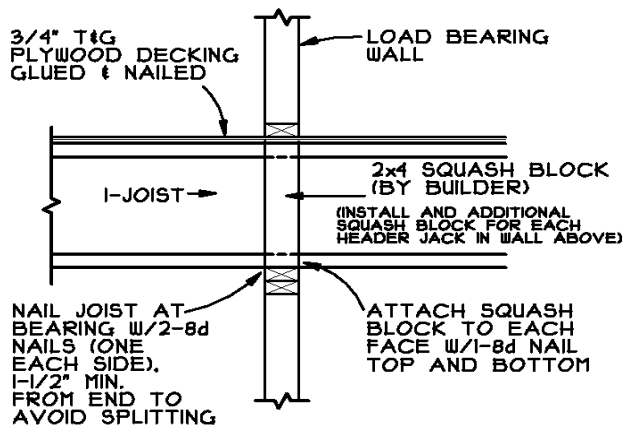

C MISSING BLOCKING SOLUTIONS

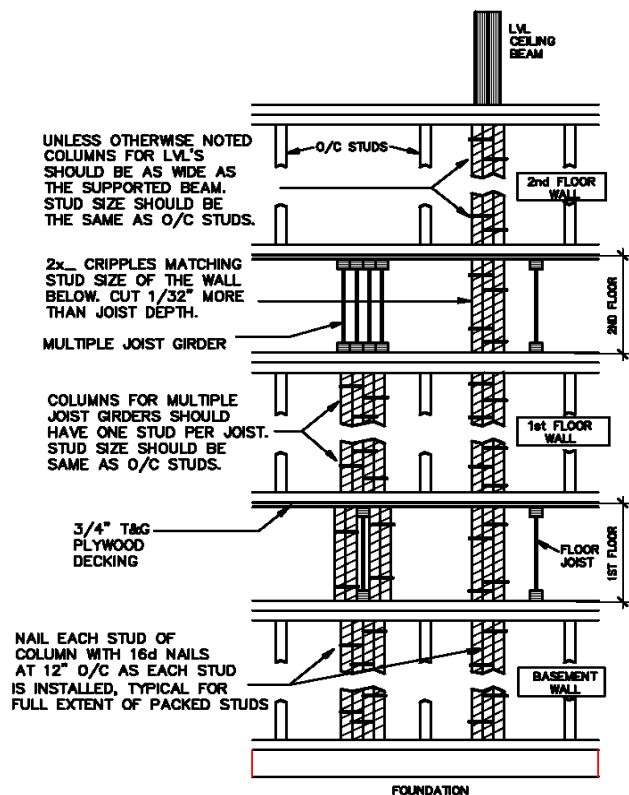

E POINT LOAD PACKING
BL013

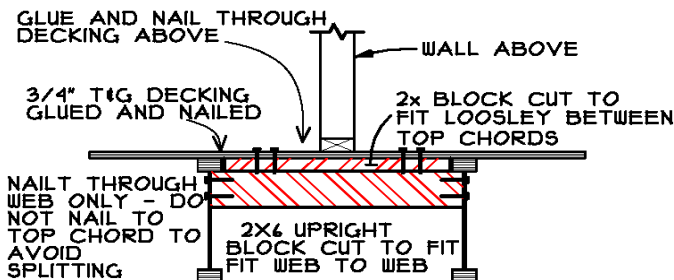

B T-BRACING AT LOADS

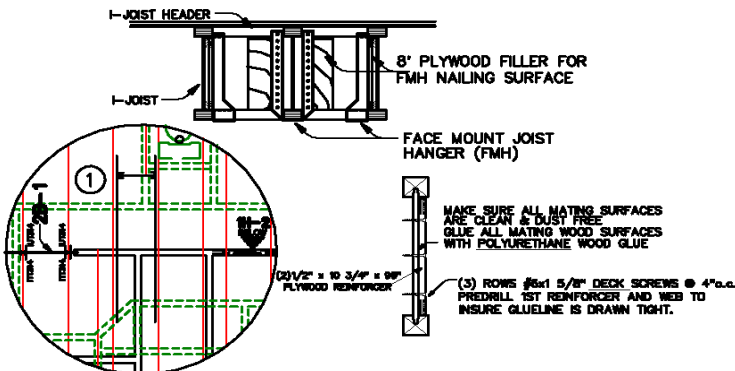
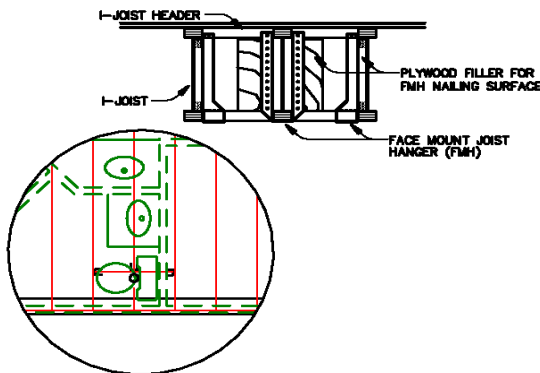

D DAMAGED JOIST HEADER

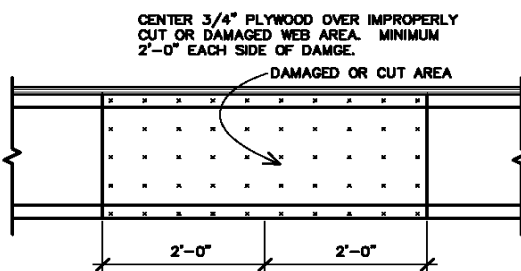
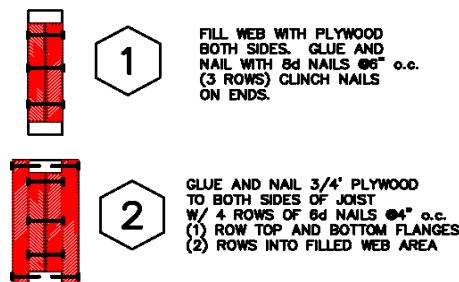

F DAMAGED WEB AREA